

KIP-600P

Fiber Inspection Probe



Product Features

- 400 times magnification, the fiber end face is clearly visible.
- Less than 1 μ m resolution, clear imaging.
- USB Port compatible with the PCs and Laptops(Windows), OTDR(Komshine)
- Applicable for UPC: SC/ FC/ ST/ LC/ SC Female/LC Female(Included)
Applicable for APC: SC/SC Female(Optional)
- Quick focus manually.
- Light weight and portable, simple operation.

Product Features



400x
magnification



Available 8
connectors



USB
-Port



One-step
process



Recognition
accuracy 1 μ m

Universal Compatibility



Applicable for UPC: SC/ FC/ ST/ LC/
SC Female/ LC Female(Included)
Applicable for APC: SC/SC Female(Optional)



SC
(APC Optional)



FC



ST



LC



SC Female
(APC Optional)



LC Female
(APC Optional)

How to use it ?

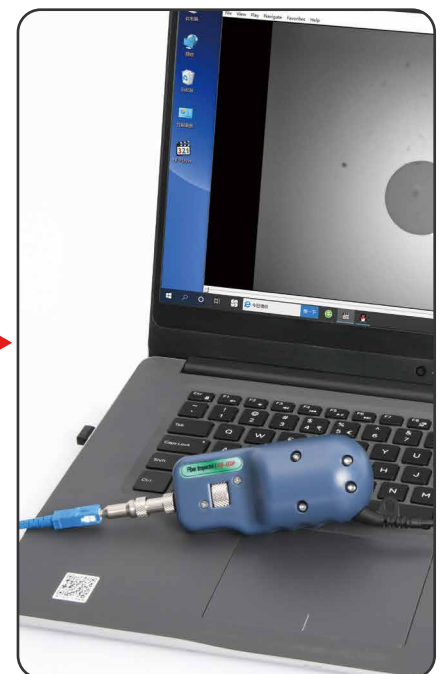
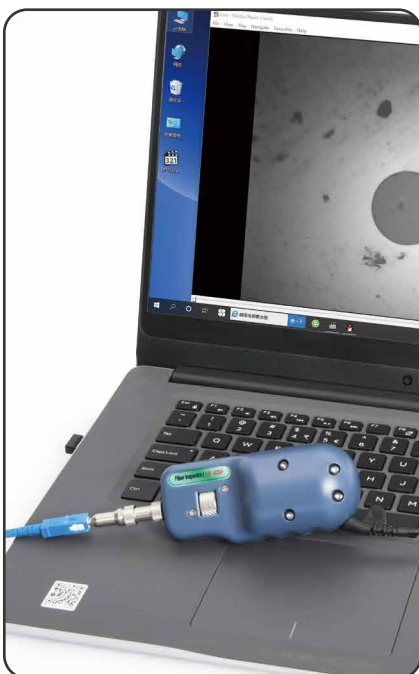

Products Pictures

Type	KIP-600P probe
Magnification	400X
Focusing method	Manual
Connectors	Applicable for UPC: SC/ FC/ ST/ LC/ SC Female/LC Female(Included) Applicable for APC: SC/SC Female(Optional)
Video signal format	NTSC/PAL
Storage Temperature	-20°C~50°C
US Port	PCs and Laptops(Windows), OTDR(Komshine)

Products



HEAD OFFICE

KomShine Technologies Limited

CONTACT US

Add: 2F Bldg. D Qinheng Tech. Pk. Nanjing, JS, 210001, China

TEL: +86 (025) 66047688

www.komshine.com

ventas@komshine.com

* Komshine reserves the right to improve, enhance, or modify the features and specifications of KomShine products without prior notification.

*Company and product names appearing in this catalogue are registered marks or trademarks of respective companies.

* This catalogue is printed using environmentally friendly paper and ink.